

### Lateral Tongue Localizing (LTL) Stent

Part Name	Model #	Incisal Separation	Tongue Placement	MSRP
Lateral Tongue Localizing Stent	LTL-0101	1.5 cm	Left/ Right (reversible)	

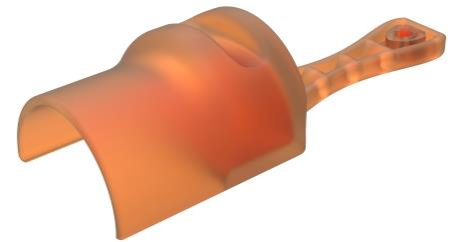

### Mouth Open Tongue Forward (MOTF) Stent

Part Name	Model #	Incisal Separation	Tongue Placement	MSRP
Vertical Displacement MOTF Small	MOTF-0201	1.5 cm	Forward over the lower incisors, under the paddle	
Medium	0202	2 cm		
Large	0203	2.5 cm		
Extra Large	0204	3cm		
XXL	0205	3.5cm		

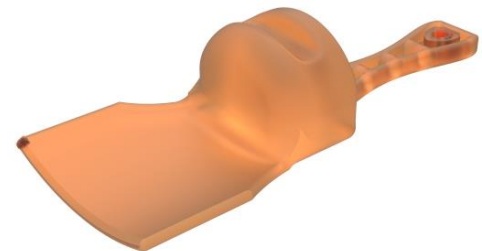

### Mouth Open Tongue Depressed (MOTD) Stent

Part Name	Model #	Incisal Separation	Tongue Placement	MSRP
Vertical Displacement MOTD Small	MOTD-0301	1.5 cm	Flat against the floor of the mouth	
Medium	0302	2 cm		
Large	0303	2.5 cm		
Extra Large	0304	3cm		
XXL	0305	3.5cm		
XXXL	0306	4cm		



### OpenBite™ Registration System

Part Name	Model #	Incisal Separation	MSRP:
Small OpenBite™ Registration Arch	OP-1001	1.2 cm	
Standard OpenBite™ Registration Arch	OP-1002	1.5 cm	
OpenBite™ Registration Add on Blocks	OP-1010	.25 cm	

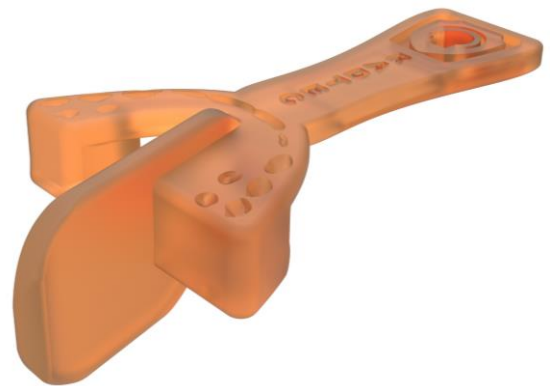

### Custom Intraoral Positioning Device (IPD)

Part Name	Model #	Incisal Separation	Tongue Position	MSRP:
Custom IPD	IPD- 1101	1.2 cm- X cm	User Defined	